

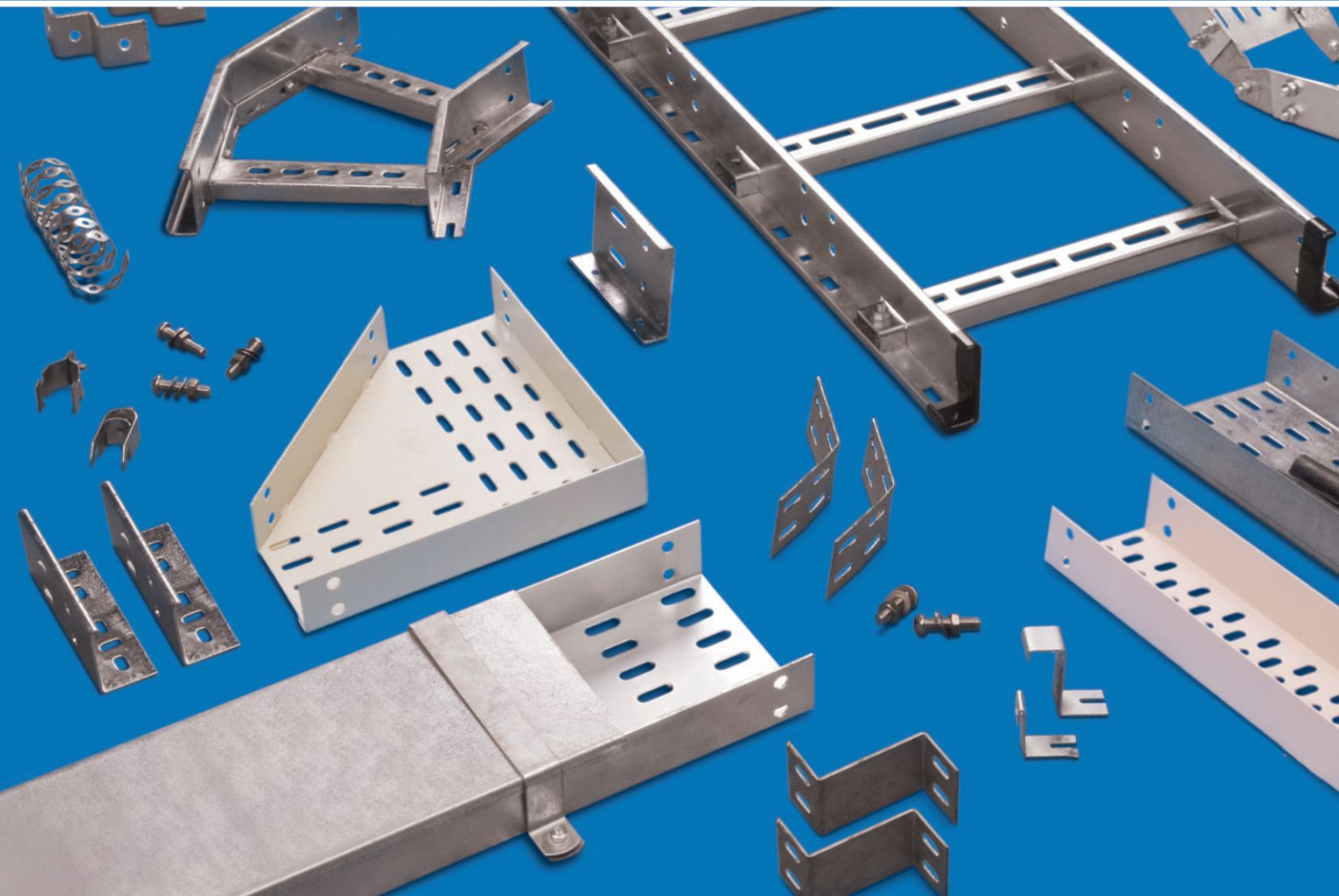

PROFAB

PROFAB ENGINEERS PVT. LTD.

WIREMESH CABLE TRAY SYSTEMS



ABOUT PROFAB ENGINEERS

M/s Profab Engineers Pvt Ltd (Indo-German Joint Venture (PUK GROUP)) as one of the top Cable management systems & solution provider on pan India Basis. We are Catering Indian Market from last 30 years to almost every vertical such as Railway, Power Infra, Automotive, Infra, Pharma, IT, FMCG etc. Creating landmark projects, Providing Solutions to client problem, supplying Good Quality products with on time delivery, set us apart from the competition and make us a trusted brand by many elite customers like L&T, Siemens, Godrej, TCS, Voltas, Honeywell etc.

We are strategically located at Navi Mumbai with 4 manufacturing Units, total manufacturing capacity of 12000 Mt of only cable

management system. Our design & engineering team work in tandem with client & Consultant to provide technical and cost competitive solution for problems faced at site. So that project can be completed with quality finish. Our focus is mainly on showing how simple modular support system can be used to solve most of the problems faced on site due to changes in drawings or revisions, and also to achieve cost saving for the client. Our Prefabricated hot dipped modular support systems and Clamping accessories will be very use full in your project installations for making supports of cable trays, race ways, trenchers, Trunking, Cable management System.











LIST OF PRODUCTS IN PROFAB CABLE MANAGEMENT BASKET





- Perforated Cable Tray
- Welded Rung Ladder Cable Tray
- Bolted Rung Ladder Cable Tray
- Wiremesh Cable Tray
- Raceways Cable Ducts
- Bolted Cable Ducts
- Access Box
- Junction Box
- Clamps
- Flexi Rack Support System
- Boltable Rack Support System
- C Strut Support System
- Punched Angle Support System
- Heavy Boltable Support System
- Solar Support Structure

SURFACE TREATMENTS DEPENDANT ON APPLICATION ENVIRONMENT

Environment	Electro - Galvanised	Power coat	Hot. Dip. Galvanised	SS 304	SS 316
Indoor Installation In Normal Environments	✓	✓	✓	✓	✓
Outdoor Installation In Normal Environments	✓	✓	✓	✓	✓
Marine Environments	✗	✓	✓	✓	✓
Alkaline Environments	✗	✓	✓	✓	✓
Acid Environments	✗	✓	✓	✓	✓
Chemical and Petrochemical Industries	✗	✓	✓	✓	✓
Food Production Environments	✗	✓	✓	✓	✓
Tunnels	✗	✓	✓	✓	✓

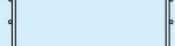
✓ High ✓ Good ✓ Possible ✗ Not recommended

Part Description	Product Code	Width in (MM)	Height in (MM)	Thickness in Dia. (MM)	Weight in Kgs/ Length	Surface Finish				Loading in Kgs		
						HOD	PC	SS304	SS316	1.2 Mtrs	1.5 Mtrs	2.0 Mtrs
	WM1005045	100	53	4.5	3.01					80	55	30
	WM1505045	150	53	4.5	3.20					80	55	30
	WM2005045	200	53	4.5	4.15					100	70	40
	WM2505045	250	53	4.5	4.34					100	80	40
	WM3005045	300	53	4.5	5.29					115	80	45
	WM4005045	400	53	4.5	6.42					115	80	45
	WM5005045	500	53	4.5	7.56					115	80	45
	WM6005045	600	53	4.5	8.70					150	105	60

Part Description	Product Code	Width in (MM)	Height in (MM)	Thickness in Dia. (MM)	Weight in Kgs/ Length	Surface Finish				Loading in Kgs		
						HOD	PC	SS304	SS316	1.2 Mtrs	1.5 Mtrs	2.0 Mtrs
	WM10010045	100	103	4.5	4.15					100	70	40
	WM20010045	200	103	4.5	6.29					125	85	60
	WM30010045	300	103	4.5	6.42					150	105	60
	WM40010045	400	103	4.5	7.56					150	105	60
	WM50010045	500	103	4.5	8.70					150	105	65
	WM60010045	600	103	4.5	9.84					180	120	70

* 6 mm Dia wiremesh trays Available on request

BENDS FOR WIREMESH TRAYS

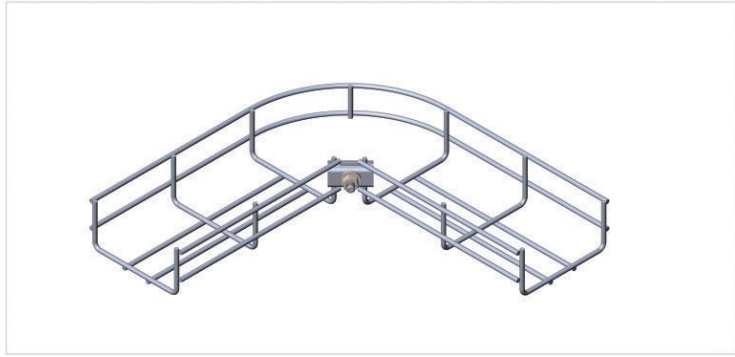

Horizontal Bend (Small Width)

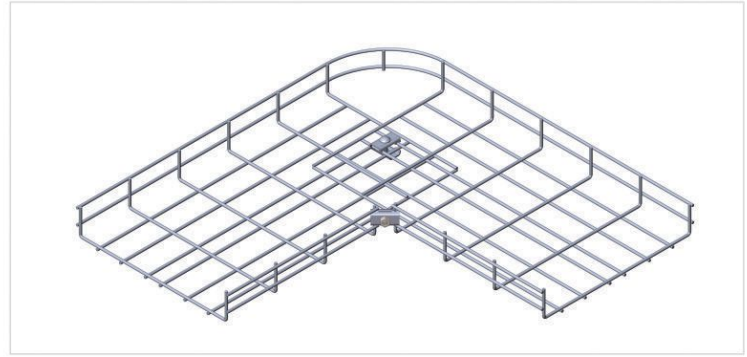

Horizontal Bend (Large Width)

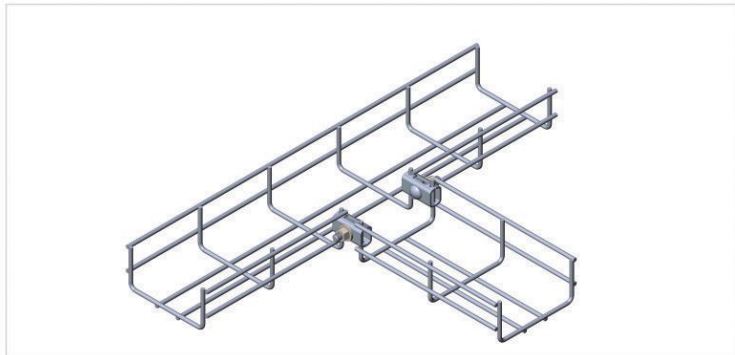

TEE Bend

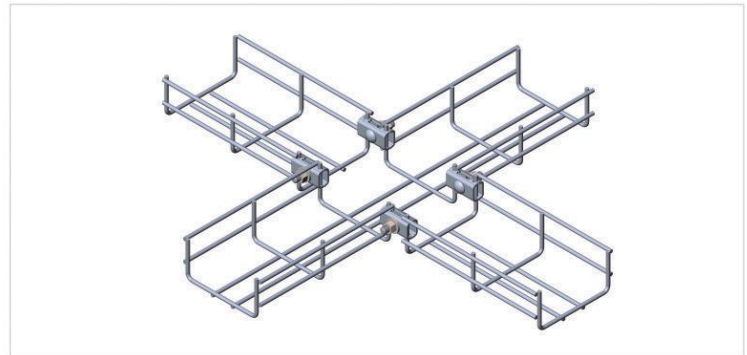

CROSS Bend

HOW TO CUT FOR BENDS

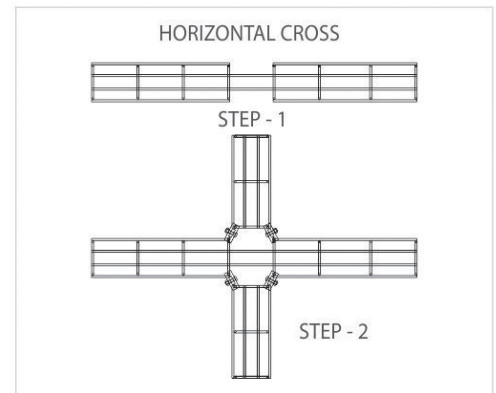
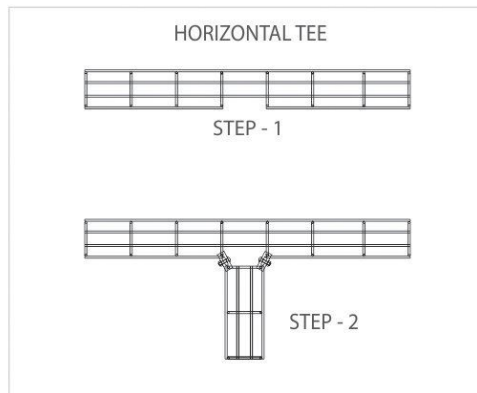
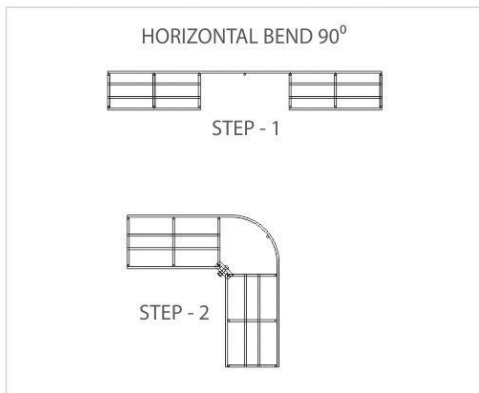

POSITIONING OF THE SPLICE (general scenario applicable to all spans)

To get the best performance from tray, choosing the right couplers is just as important as their positioning. CABLOFIL couplers have been designed and tested to provide high levels of mechanical and electrical performance. To maximise performance, follow the recommendations below:

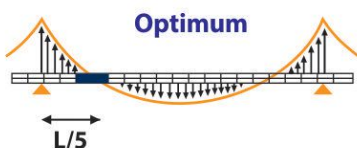

100% PERFORMANCE
For best results, place the couplers at $1/5^{\text{th}}$ of the way along span.

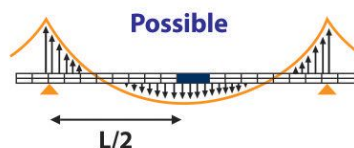

70% PERFORMANCE
If the coupling is at $L/2$, a coefficient of 0.7 should be applied to the permissible load.



Never put the support under coupler.

ACCESSORIES & HARDWARE

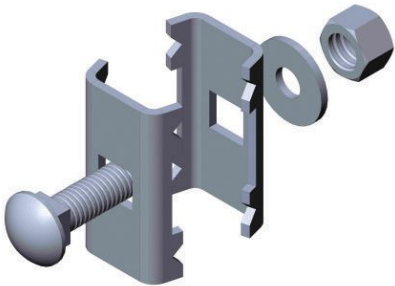

Normal Coupler

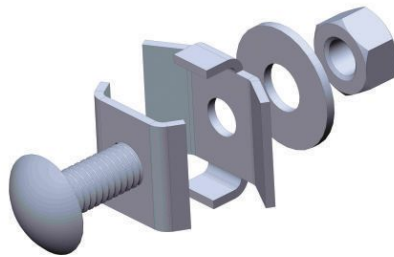

Horizontal Coupler

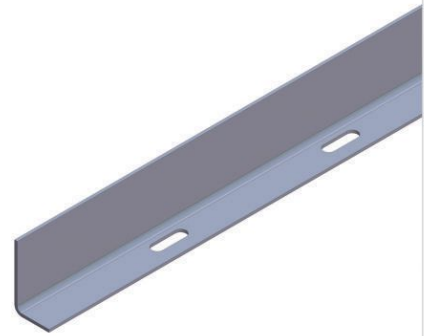

Partition

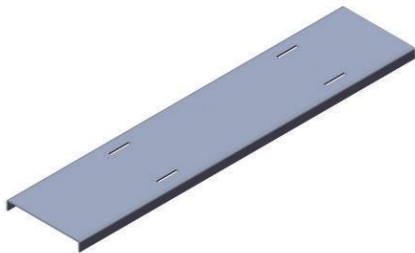

Cover

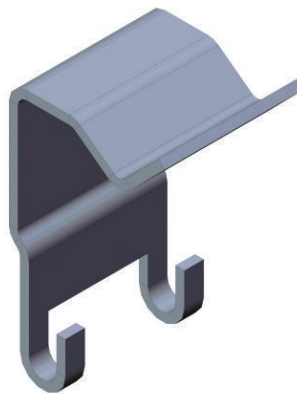

Cover Toggle Clamp



Waterfall Bend



Hinge Coupler

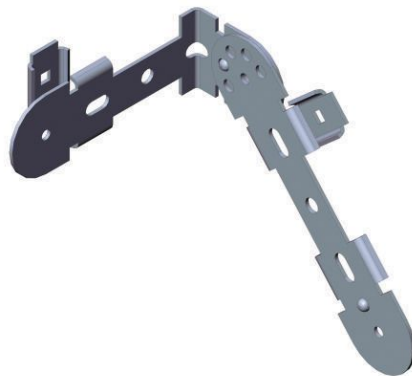

Tee Drop Coupler

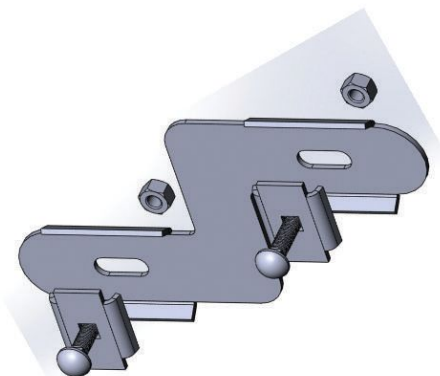

Step Down Coupler

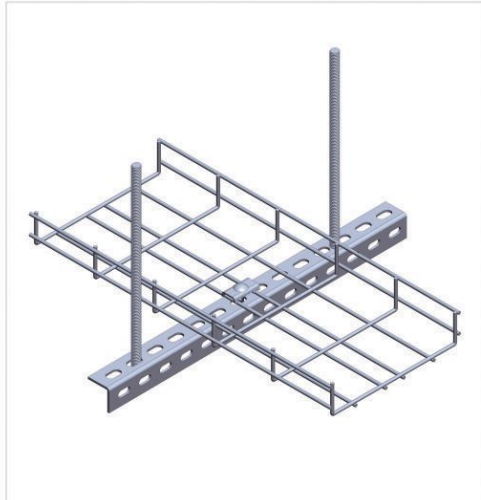

Threaded Rod with Angle Below

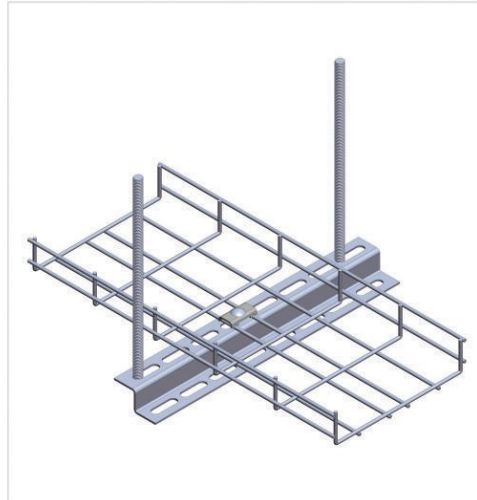

Threaded Rod with Z- section Below



Threaded Rod with C- section Below



Threaded Rod with Bottle Bracket

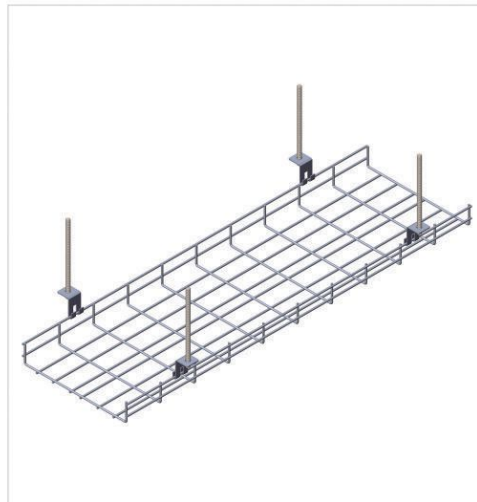

Threaded Rod with Hanger Hook

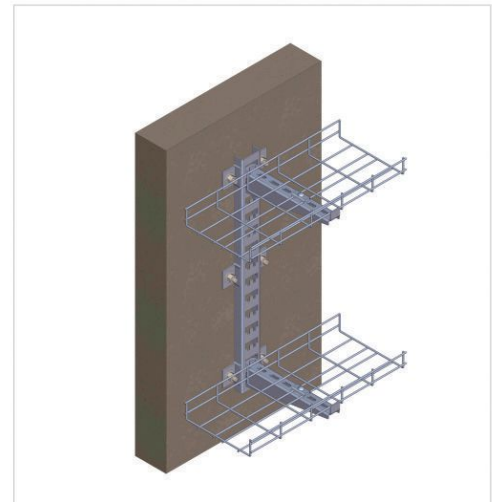

Cable Tray on Wall with FRK Multi Teir

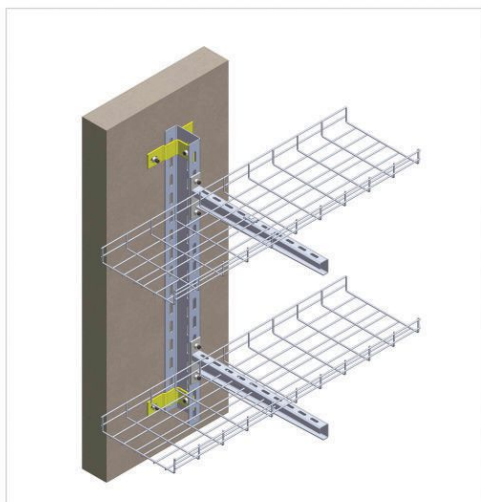

Cable Tray on Wall with BRK Multi Teir

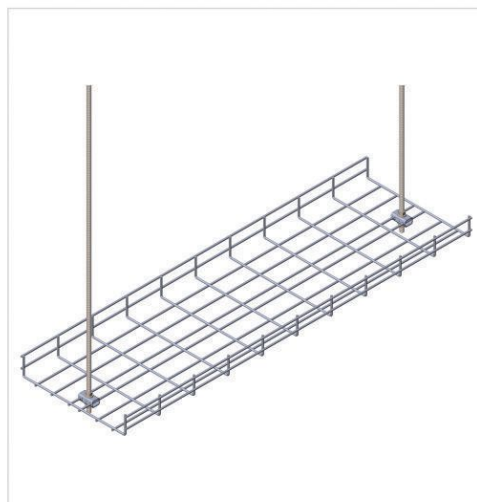

Single Threaded Rod in between with Clamp

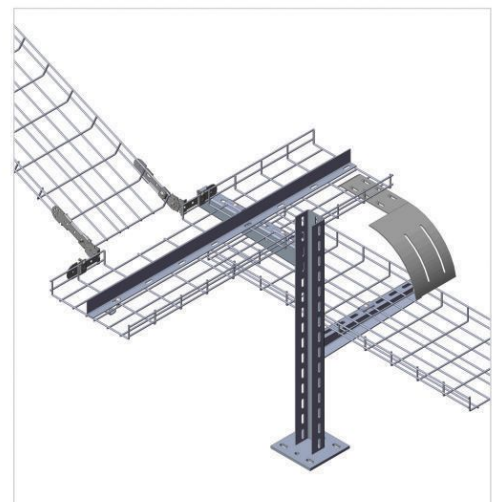

Under False Floor Support System

1. Deflection Test as per IEC61527
2. Electrical Continuity Test
3. Short Circuit Test

* Report available on request



LIST OF VALUED CLIENTS

- INSPIRA (SBI Data Center Hyderabad)
- Mani Dairy Chennai
- AT&T (ITC Kapurthala)
- Adisoft Technologies (Maruti Gurgaon)
- Tetra Pack (ITC)
- Supertech (ITC Haridwar)
- Union Bank of India Mumbai
- Fiserv India Pvt. Ltd. (S&W)
- MEHO - HCP Air System
- NESTLE

LIST OF MAJOR PROJECTS FOR PROFAB CABLE MANAGMENT SYSTEM

FINANCIAL INSTITUTIONS

- HSBC (incl. Srilanka)
- ICICI Bank
- IDBI Bank
- SBI
- National Stock Exchange
- CITI Bank

IT COMPANIES

- Microsoft Phase I, II, & III,
- Symantec
- Wipro
- TCS
- Hewlett Packard
- Cisco
- Intel
- SAP Labs
- McAfee
- Oracle
- Cognizant
- Dell

OTHER INDUSTRIES

- ITC Bangalore
- Saint Gobain glass
- Asahi glass
- Hindustan Zinc
- BASF Chemicals
- Moser Bear
- Colgate
- Unilever
- P&G
- Norvartis
- Astra Zenacca
- Bosch
- Sun Pharma
- Teva Pharma
- Hospira
- Adani Wilmar Limited



**PUK GROUP HQ,
BERLIN, GERMANY**

INDIAN SUBSIDIARY CONTACT DETAILS

HEAD OFFICE & PLANT

PROFAB ENGINEERS PVT. LTD. (Unit - I)

W-310, T.T.C. Industrial Area, Pipeline Service Road, Opp. Anthony Garage, Rabale, Navi Mumbai - 400 701, India.

Phone: +91 022 27604354/55 • Fax: + 91 022 27607298 • Email: enquiry@profabengineers.com • www.profabengineers.com

PROFAB ENGINEERS PVT. LTD. (Unit - II)

Plot No. 15, 16 & 21/8, Chickloli, Old Swastik Compound, Morivali Village, M.I.D.C., Ambarnath (W.), - 421 505, India.

Phone: + 91 70456 99110 • Email: ambarnath@profabengineers.com

BRANCH OFFICES

PROFAB ENGINEERS PVT. LTD. (New Delhi)

Room No. 203, Vikas Plaza, (Near Banaras House), Local Shopping Complex, 42, Moreland, Kalkaji, New Delhi, - 440 019.

Mobile: +91 98104 25372 • E-mail: delhi@profabengineers.com

PROFAB ENGINEERS PVT. LTD. (Bangalore)

No. 37 / 2, Navodaya Apts., Ground Floor, 2nd Main, Binny Mill Road, Ganga Nagar Extn. Bangalore - 560 032, India.

Phone: +91 080 32418474 • Mobile: +91 93428 71444 • E-mail: bangalore@profabengineers.com

PROFAB ENGINEERS PVT. LTD. (Chennai)

23/07, Asian Ashok Apartment, Dr. Ambedkar Road, Kodambakkam, Chennai - 600 024, India.

Telefax: +91 044 24802966 / 24836410 • E-mail: chennai@profabengineers.com

PROFAB ENGINEERS PVT. LTD. (Hyderabad)

C/o. Mr. G.Ramamurthy, No.25, Jeera, Near Secunderabad Boat Club, Secunderabad - 500 003, India.

Phone: + 91 044 66337205 • Mobile: +91 93924 08589 • E-mail: hyderabad@profabengineers.com

PROFAB ENGINEERS PVT. LTD. (Vijaywada)

Phone: +91 93467 93473 • E-mail: vjw@profabengineers.com

PROFAB ENGINEERS PVT. LTD. (Kolkata)

Phone: +91 73845 86531 • E-mail: kolkata@profabengineers.com